



TABLE OF CONTENT

1. GENERAL.....	3
2. OFFICIALS	3
3. COMMUNICATIONS / TELECOMS.....	3
4. NATIONAL SAFETY SERVICES.....	4
5. SAFETY ARRANGEMENTS OF THE CIRCUIT	4
5.1. SAFETY OF THE SPECTATORS.....	4
5.2. SAFETY OF THE COMPETITORS/DRIVERS	5
5.3. SAFETY OF THE OFFICIALS.....	5
6. SAFETY AND RESCUE UNITS	6
6.1. EVENT MEDICAL PROVISIONS	6
6.2. CIRCUIT SAFETY PROVISIONS	7
7. INCIDENT PROCEDURES	7
7.1. ON TRACK	7
7.2. OFF TRACK	8
7.3. MAJOR DISASTER PLAN	8
8. CIRCUIT MAP(S)	8
9. SAFETY ARRANGEMENTS OF THE Paddock.....	16
10. SAFETY AND RESCUE UNITS	16
11. INCIDENT PROCEDURES	16
12. Paddock MAP(S).....	16
13. MEDIA MAP.....	21



2019 FIA EUROPEAN AUTOCROSS CHAMPIONSHIP

Autocross of Autocross of Cunewalde, Germany
Matschenberg Offroad Arena – Cunewalde

Germany, 28-30 June 2019

EVENT SAFETY PLAN



1. GENERAL

The present safety plan concerns the second round of the 2019 Autocross European Championship scheduled for 29./30.06.2019 , at Matschenberg – Offroad arena, Cunewalde Germany.

The Matschenberg Offroad Arena circuit is the holder of a grade 6A licence issued by the FIA on 11.10.2018, and valid from 11.10.2018.

Moreover, the present safety plan undertakes to respect the provisions, recommendations and requirements specified in Article 3 of Appendix H (recommendations concerning the surveillance of the route and the intervention services). This notwithstanding, each organiser is permitted to add to this anything that might improve the safety of the spectators, competitors and drivers, as well as the safety of the officials.

2. OFFICIALS

In all matters pertaining to the above competition, the local officials (below) are the key people to contact in case of emergency and/or incident.

- Clerk of the Course: **Karsten Ney** +49 1713831578
- Deputy Clerk of the Course: **Rainer Ahlf Burhop**
- Secretary of the Event: **André Poick**
- Safety Officer: **Toni Rycer** +491627742548
- Chief Medical Officer: **Dr. Matthias Purfürst** +49 171771684
- Deputy Chief Medical Officer: TBA
- Chief Scrutineer: **Ulrich Nolte**
- Paddock Officer: **Andreas Hempel** +49 1705638020
- Pre-Grid Area Officer: **Christian Frindt** +49 1722709962
- Starter: **Hagen Stübner** +49 1729271116
- Chief of track maintenance reconstruction team: **Henry Dietrich**

NB: The officials responsible for the operational running of the event will be located at start/finish building during the whole event.

3. COMMUNICATIONS / TELECOMS

A telephone landline connect the main/race control building with the German telephone network. This is of course available for emergencies.

All responsible officials/services (race control, medical and rescue, firefighters, marshals, paddock etc.) are connect by radio.



NB: A telephone landline must be provided (free of charge) for emergencies.

4. NATIONAL SAFETY SERVICES

POLICE: **+49 110 Polizeidirektion Görlitz**

HOSPITAL(S): **+49 3591 – 3630; Oberlausitzer Kliniken GmbH
Am Stadtwall 3
02625 Bautzen**

**+49 3586 – 7620; Krankenhaus Ebersbach-Neugersdorf
Röntgenstraße 23
02730 Ebersbach**

EMERGENCY MEDICAL SERVICES: **by radio, ASB KV Bautzen e.V.
Czornebohstraße 2
02625 Bautzen**

FIRE-FIGHTING SERVICES: **by radio, FFW Cunewalde**

BREAKDOWN SERVICES: **by radio**

RED CROSS (or equivalent): **by radio; ASB KV Bautzen e.V.
Czornebohstraße 2
02625 Bautzen**

5. SAFETY ARRANGEMENTS OF THE CIRCUIT

5.1. SAFETY OF THE SPECTATORS

A. Details of where the rescue services are stationed

The rescue services are stationed in the main spectator area. The ambulance can from this area access anytime the public roads.

B. Instruction for intervention (in case of accidents, incidents and dangerous situations)

In case of accidents, incidents and dangerous situations are the rescue staff instructed appropriate their tasks

C. Evacuation routes

NB: Please kindly indicate the direction of traffic flow / the direction in which to enter and leave the circuit. In addition, please note that a lane reserved exclusively for the use of the rescue services should be provided.

Evacuation routes are marked by signs, showing the spectators the fastest and safest way to the area exit.

D. The hospital(s) which has (have) been contacted and which would be used in the event of an emergency

Oberlausitzer Kliniken GmbH
Am Stadtwall 3
02625 Bautzen

Krankenhaus Ebersbach-Neugersdorf
Röntgenstraße 23
02730 Ebersbach

5.2. SAFETY OF THE COMPETITORS/DRIVERS

A. Details of where the rescue services are stationed

First aid staff, firefighting and police staff are located in the starting area around the starting/race control building and in the infield of the track beside marshal post 2.

B. Instruction for intervention (in case of accidents, incidents and dangerous situations)

In case of accidents, incidents and dangerous situations are the rescue staff instructed appropriate their tasks.

C. Evacuation routes

Evacuation routes are marked by signs, showing the fastest and safest way to the area exit. After the race is stopped the race track is free for evacuation activities.

D. The hospital(s) which has (have) been contacted and which would be used in the event of an emergency

Oberlausitzer Kliniken GmbH
Am Stadtwall 3
02625 Bautzen

Krankenhaus Ebersbach-Neugersdorf
Röntgenstraße 23
02730 Ebersbach

5.3. SAFETY OF THE OFFICIALS

A. Details of where the rescue services are stationed

First aid staff, firefighting and police staff are located in the starting area around the starting/race control building and in the infield of the track beside marshal post 2. Additional is one firefighter staffed at each marshal post.

B. Instruction for intervention (in case of accidents, incidents and dangerous situations)

In case of accidents, incidents and dangerous situations are the rescue staff instructed appropriate their tasks.

C. Evacuation routes

Evacuation routes are marked by signs, showing the competitors/drivers the fastest and safest way to the area exit. After the race is stopped the race track is free for evacuation activities.

- D. The hospital(s) which has (have) been contacted and which would be used in the event of an emergency

Oberlausitzer Kliniken GmbH
Am Stadtwall 3
02625 Bautzen

Krankenhaus Ebersbach-Neugersdorf
Röntgenstraße 23
02730 Ebersbach

6. SAFETY AND RESCUE UNITS

6.1. EVENT MEDICAL PROVISIONS

Ambulances: The medical centre is placed in the starting area and a second in the track infield beside marshal post 2. All necessary medical devices are there. Cold and hot water is available. The medical centre is staffed by one doctor and minimum 3 paramedics. The communication runs by radio

Extrication vehicle/ Medical intervention vehicle:

The extrication/medical intervention is placed in the infield of the circuit across from the main/race control building. All necessary medical devices are there. The vehicle is staffed by one doctor and one paramedic. They're connected with the CoC, Safety Officer and the doctor outside the track by radio.

Medical Unit: The medical rescue service is ensured by 3 ambulances and minimum 12 trained ambulance officers along the circuit. All ambulance officers are equipped with a first aid box and a stretcher. The communication runs by radio.

Fire tender: One fire truck is placed beside the main/race control building, one in the infield of the track beside marshal post 2. Each truck is staffed with minimum 2 firefighters. All necessary firefighting devices are in the trucks. The firefighters are communicate by radio with the CoC and the Safety Officer.

Fire points/extinguishers: On each marshal post is minimum one 5kg powder extinguisher

Tow trucks: In the start area are located appropriate towing vehicles with hooks as well as lifting vehicles available. For circuit service appropriate tools will be used. The complete application of all technical devices will be coordinated by the Safety Officer. All including staff (6 worker) is connected by radio.

In addition, is/are there :

- Doctors or paramedics on foot ?

Yes / No

Minimum 2 paramedics are staffed in the starting area and the infield of the track beside the marshal post 2. They are equipped with necessary devices and radios.

- How far is a medically-equipped helicopter ?

60 km



• Transfer time (Medical Centre - Hospital) is more than 20 minutes, have you contacted the HEMS (Helicopter Emergency Medical Service) ? **Yes / No**

Transfer time (Medical Centre - Hospital) will be maximum 15 minutes by ambulance. To contacted the HEMS (Helicopter Emergency Medical Service) due decision of the Chief Medical Officer.

6.2. CIRCUIT SAFETY PROVISIONS

Startline: The start area is staffed by 1 fire brigade, the Extrication Team (in the infield), 1 rescue car, connected by radio. Minimum 6 powder extinguisher are available.

Paddock: In the paddock is placed 1 fire truck, fire extinguishers, 1 ambulance unit. The whole area is controlled by firefighters and the organisation staff, composed of minimum 2 people.

Scrutineering area: The scrutineering area is in the paddock. There is placed 1 firefighting point with the necessary equipment (extinguisher, shovel, axe).

Marshall Posts: Located along the track are 9 marshal posts, number 1 – 9, with trained staff (on each post minimum 2 marshals) and fire fighters, equipped with a set of signal flags (ISC, Appendix H). The communication to the Safety Officer accessible by radio.

Reconstruction, anti-dust treatment and watering procedures, including control of track safety equipment (like track edge markers replacing, tyre barriers reconstruction procedures etc...):

All affairs regarding track reconstruction, barriers repairing and control of track safety equipment are under the leadership of the Safety Officer. For all necessary works are sufficient staff available. Anti dust treatment and watering procedures managed the CoC. For this purpose is a mobile water barrel in the technical equipment

7. INCIDENT PROCEDURES

7.1. ON TRACK

→ **Minor incident**

The track is not completely blocked:

Action according to the regulations to be exercised by marshals (waving the yellow flags).

Check through visual or verbal contact if the driver are injured and whether he needs to be recovered.

In this case have the marshal inform the CoC and the Safety Officer via radio immediately in order to prepare the stopping of the race (will be signed by the CoC with the red flag).

When an ambulance car is called into operation and has to enter the track, first the practice or race has to be stopped by means of showing the red flag, so that the ambulance car, the doctor and the ambulance men can proceed to the place of accident without danger.

If is not the case (the driver is not injured), the practice or race can continue.

→ **Serious accident**

The track is completely blocked:

Following the report of the Safety Officer or the marshals the CoC immediately orders the stopping of the race (red flag), red revolving lights on the race tower and beside marshal post



1 left and right sides of the track.

The track staff (marshals) produce visual contact to the accident driver and speak to him. So they check the necessity of calling ambulance men and rescue vehicle of the fire brigades.

If this is necessary – the doctors or paramedics recover the injured person by using suitable tools taken aboard the fire fighting vehicle. Clear the track immediately after having recovered the injured person.

If is not the case – evacuation of the track and the practice or race can start again.

7.2. OFF TRACK

→ **Minor incident**

In the paddock: market first aid office in the paddock building with first aid equipment, one transfer vehicle are available.

Involving spectators: paddock officer informing the CoC and the Safety Officer by radio

→ **Serious accident**

In the paddock: informing the CoC and the Safety Officer, activation of the fast rescue system, when needed a rescue helicopter is called for, if necessary informing the police.

Involving spectators: informing the CoC and the Safety Officer, if necessary posting of red flag – race is interrupted, rescue vehicle, if necessary helicopter calling, informing state police.

7.3. MAJOR DISASTER PLAN

E.g Major explosion

Informing the CoC and the Safety Officer, posting of the red flag – race is stopped. Calling for the Medical rescue and the hospitals. Information to the spectators and the drivers via radio and loudspeaker with instructions. Information to the State Police.

8. CIRCUIT MAP(S)

EQUIPMENT

The following must appear on the map(s):

- ✓ Ambulances
- ✓ Fast Intervention car
- ✓ Medical intervention vehicles
- ✓ Fire tender
- ✓ Fire points/extinguishers
- ✓ Tow trucks
- ✓ Track-spraying vehicles
- ✓ Positions of the reconstruction teams
- ✓ Doctors or paramedics on foot

POSTS / AREAS

The following posts must appear on the map(s):



- ✓ Medical centre dedicated to the race
- ✓ Medical centre dedicated to the public
- ✓ Fire station
- ✓ Marshall posts
- ✓ Location of the officials (Race Director, Stewards' meeting room, FIA Observer, Clerk of the Course, Chief Timekeeper, Chief Medical Officer, Event secretariat, Secretary of the meeting, Safety Officer, Chief Scrutineer, Drivers' Liaison Officer)

The following zones must be clearly identified on the map(s):

- ✓ Prohibited/authorised areas to the public
- ✓ Spectator area
- ✓ Scrutineering area
- ✓ Paddock
- ✓ Parc fermé
- ✓ Public parking

OTHERS

The following must also appear on the map(s):

- ✓ Route and timing to the closest hospital
- ✓ Circuit entrance/exit
- ✓ Emergency exit(s) and evacuation routes



Autocross – Rennstrecke
am Matschenberg

Krankenhäuser
hospital

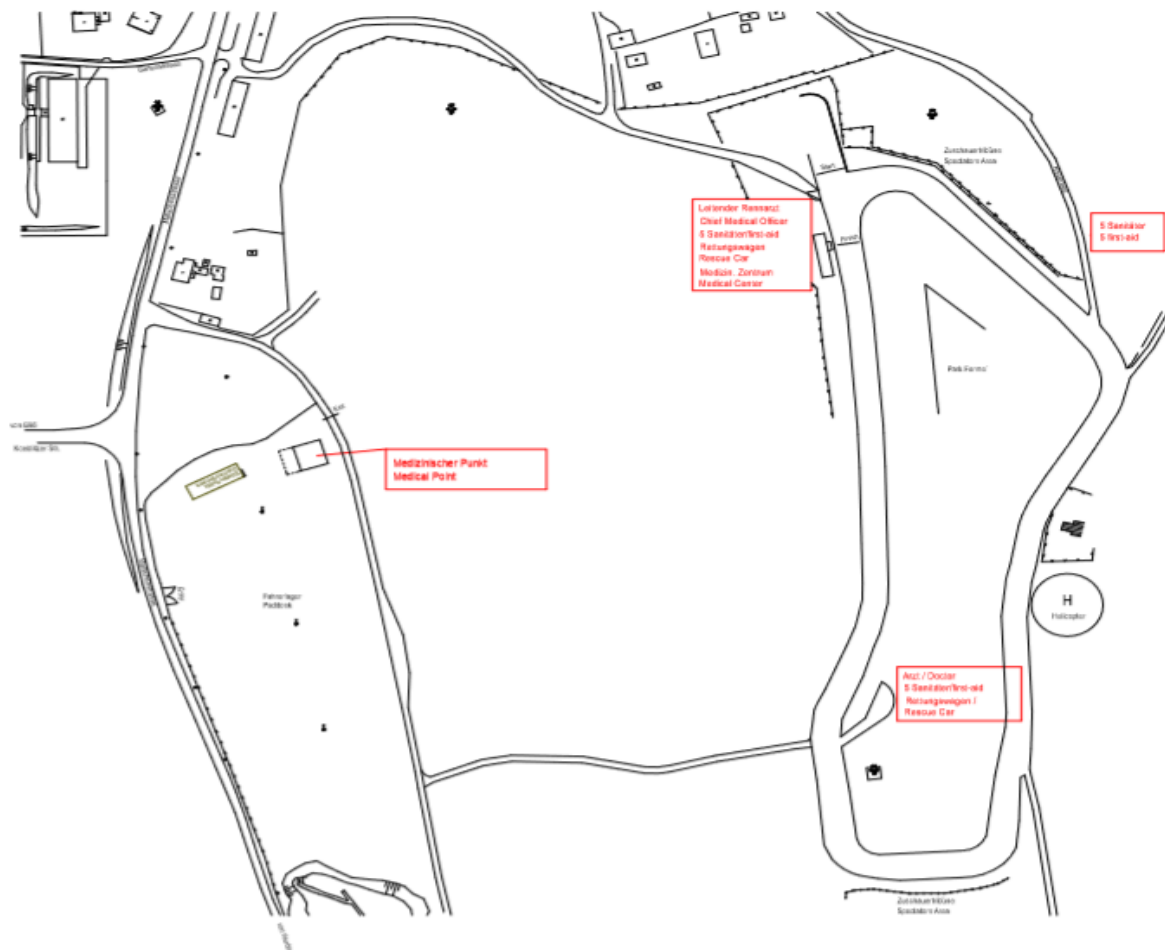

Autocross - Rennstrecke
am Matschenberg
Medizinische Kräfte
Medical

SV-Büro, Jernies Aktuel 02 2019

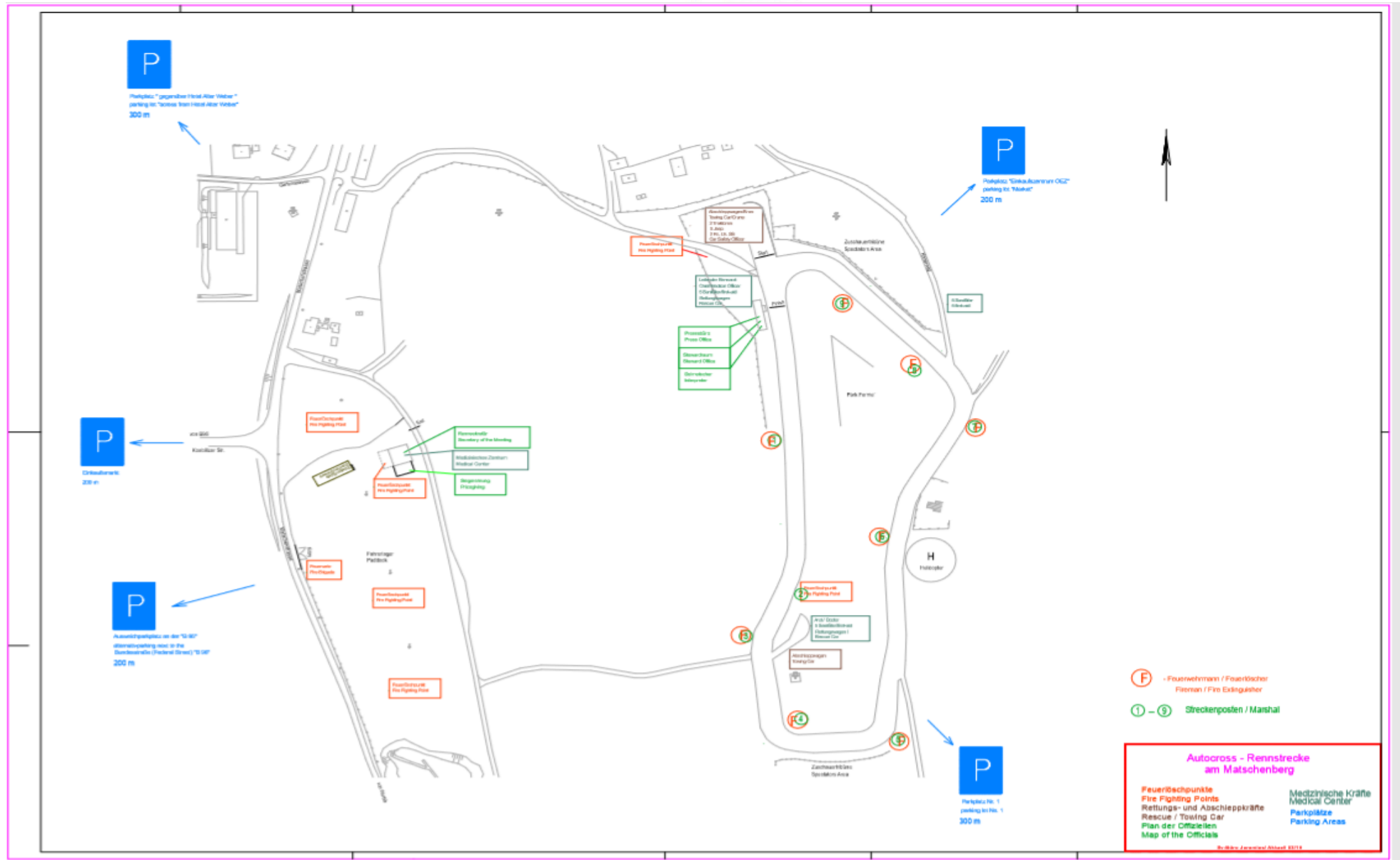

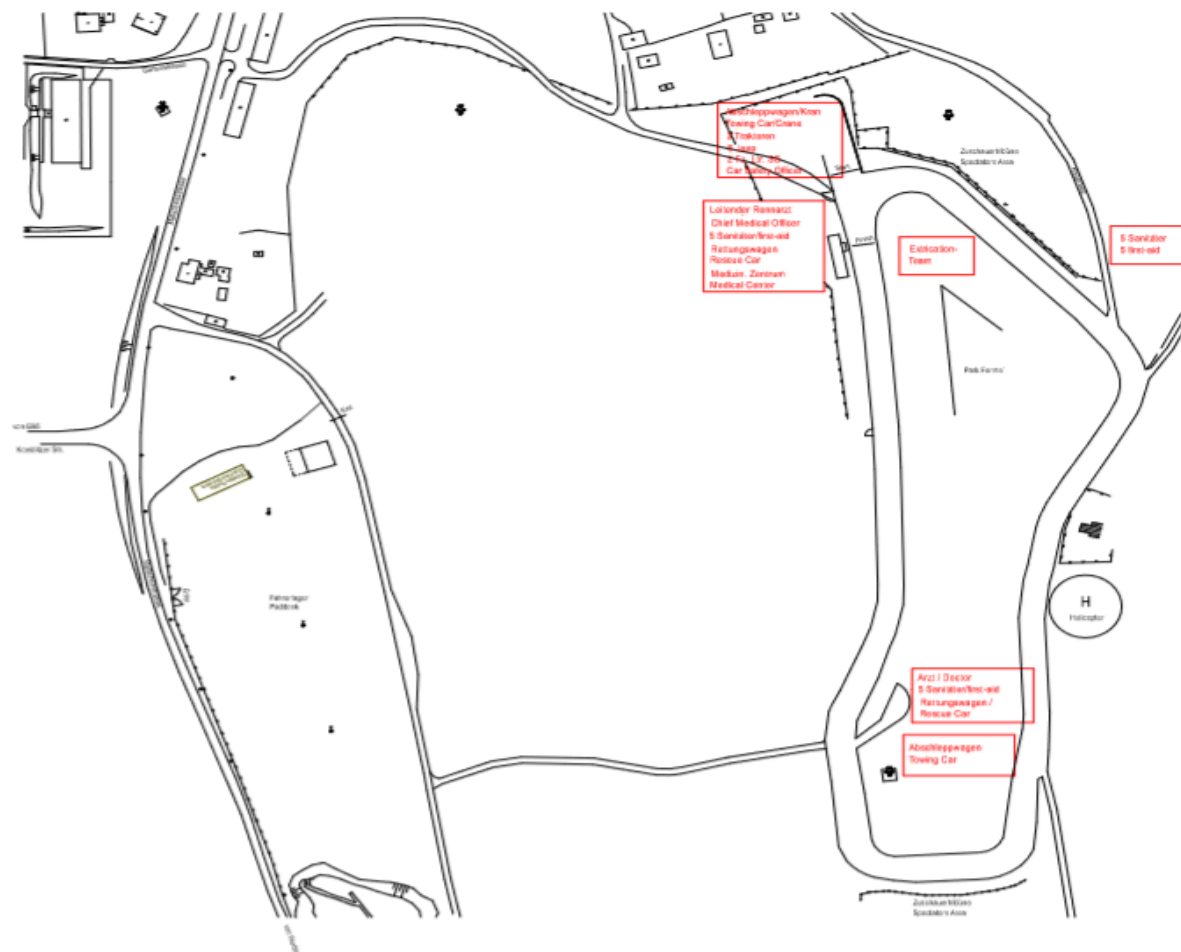

Autocross - Rennstrecke am Matschenberg

Rettungs- und Abschleppkräfte
Rescue / Towing Car

SPY- Bruno Jeronimo/ Abusail 03/2019

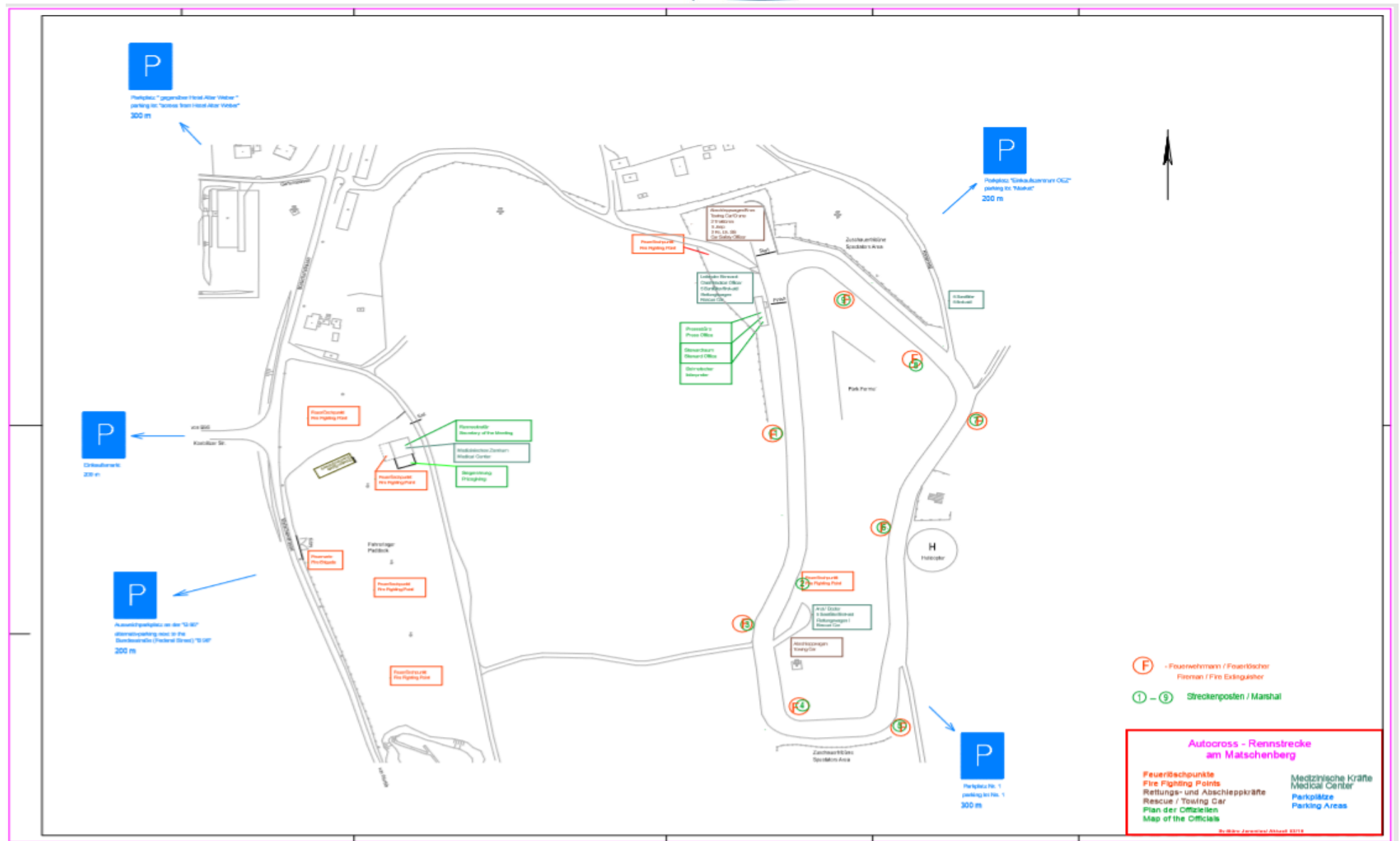



2019 FIA EUROPEAN AUTOCROSS CHAMPIONSHIP

Autocross of Autocross of Cunewalde, Germany
Matschenberg Offroad Arena – Cunewalde

Germany, 28-30 June 2019

PADDOCK SAFETY PLAN

9. SAFETY ARRANGEMENTS OF THE PADDOCK

- A. Details of where the rescue services are stationed
Medical services including the ambulance vehicle is located near the paddock building, the firefighters truck at the paddock entrance. A first aid office located in the paddock building.
- B. Instruction for intervention (in case of accidents, incidents and dangerous situations)
The paddock officer have to inform the CoC and the Safety Officer via radio. In case of need everyone in the paddock will be informed by loudspeaker in German and English language.
- C. Evacuation routes
Two exits from the paddock directly to the public roads available.

10. SAFETY AND RESCUE UNITS

Medical services in the paddock on Saturday and Sunday from 08:00 a.m. to 06:00 p.m.
Firefighters walks and control through the paddock on Saturday and Sunday during activities on track.
Firefighting and first aid equipment in the paddock building and the scrutineering area.

In addition, is there :

- Doctors or paramedics on foot ?

Yes / No

Two paramedics with necessary equipment available in the paddock.

11. INCIDENT PROCEDURES

→ See 7.2 of the Event Safety Plan

12. PADDOCK MAP(S)

EQUIPMENT

The following must appear on the map(s):

- ✓ Ambulances
- ✓ Extrication vehicles
- ✓ Medical intervention vehicles (Recovery vehicles?)
- ✓ Fire tender
- ✓ Fire points/extinguishers
- ✓ Tow trucks
- ✓ Doctors or paramedics on foot

POSTS / AREAS

The following zones must be clearly identified on the map(s):

- ✓ Prohibited/authorised areas to the public



- ✓ Car wash area

OTHERS

The following must also appear on the map(s):

- ✓ Direction of traffic flow
- ✓ Paddock entrance/exit
- ✓ Emergency exit(s)

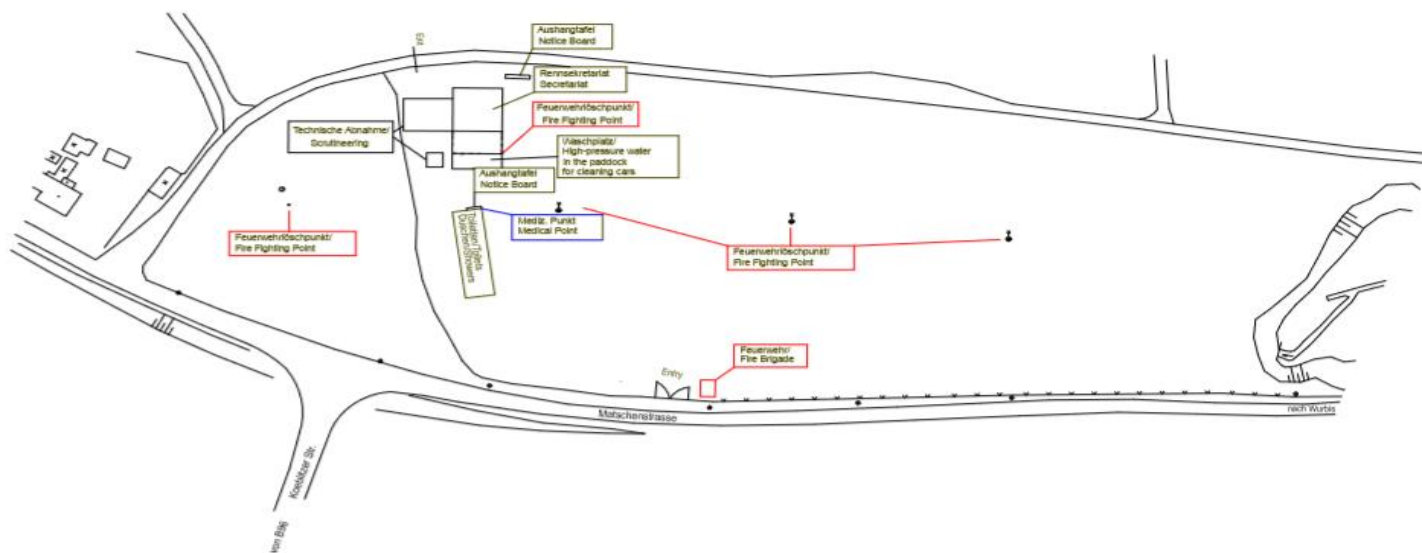

Autocross - Rennstrecke
am Matschenberg

Fahrerlager
Paddock

SV- Büro Jeremies Aktuell 03/ 2019



Fahrerlager / Paddock





2019 FIA EUROPEAN AUTOCROSS CHAMPIONSHIP

Autocross of Autocross of Cunewalde, Germany
Matschenberg Offroad Arena – Cunewalde

Germany, 28-30 June 2019

MEDIA SAFETY PLAN



13. MEDIA MAP

The following must feature on the map:

- ✓ In green, the zones authorised to the photographers and other media
- ✓ In red, the zones out of bounds to the photographers and other media
- ✓ Places where photographers are allowed to cross the track from one place to the other under supervision of a Marshall.

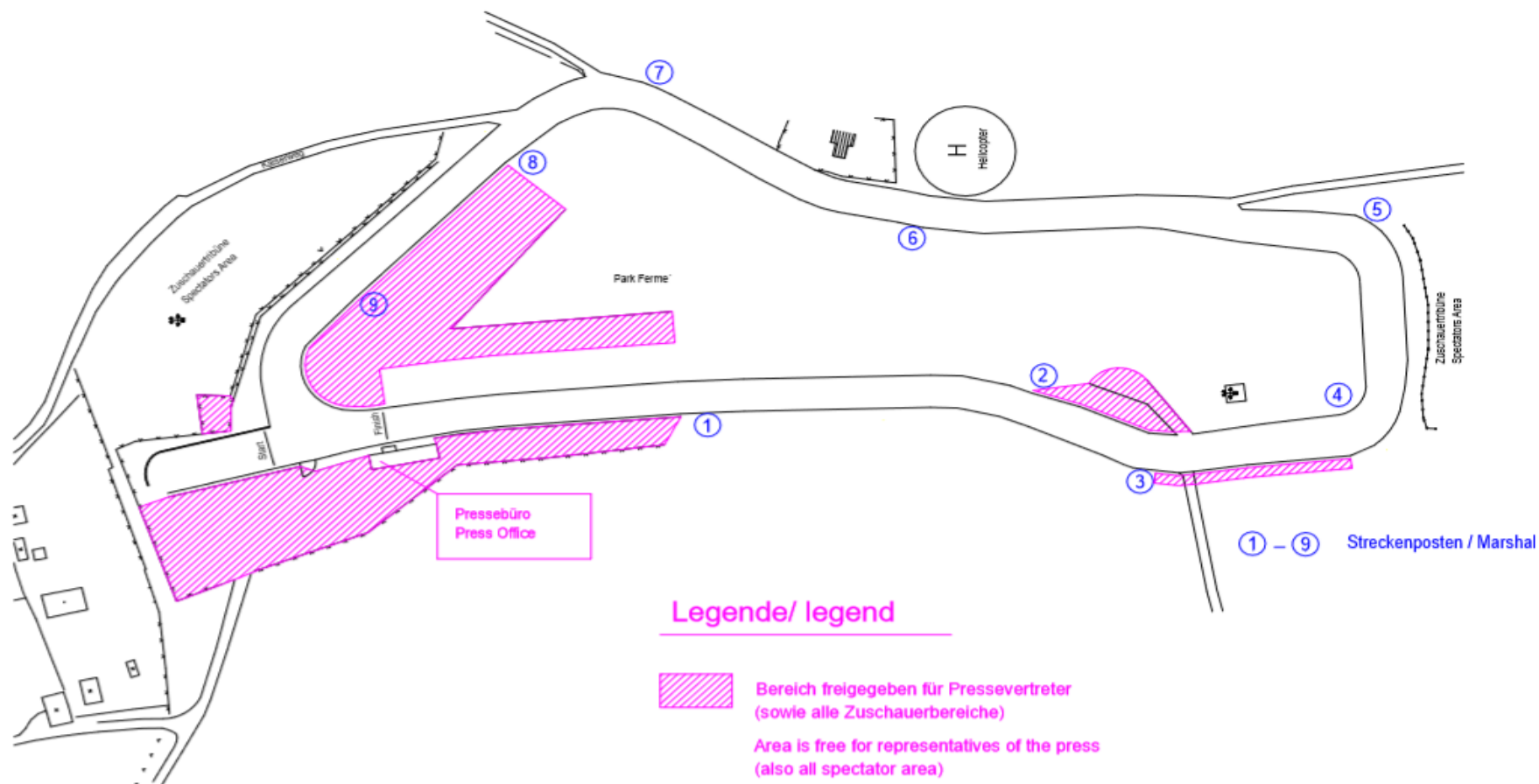

Legende/ legend



Bereich freigegeben für Pressevertreter
(sowie alle Zuschauerbereiche)

Area is free for representatives of the press
(also all spectator area)

**Autocross - Rennstrecke
am Matschenberg**

**Sicherheitsplan Pressevertreter
Press Safety Plan**

SV-Büro Jermies Aktualisiert 03/2019